

All dimensions must be checked on site and not scaled from this drawing.

Revisions

A 26 OCT 2011  
 WINDOW EXTERNAL REVEALS INCREASED TO 80MM AS REQUESTED BY PLANNING OFFICER AND PROJECTING CILLS ADDED TO WINDOWS TO DISCHARGE IN FRONT OF ASHLAR STONE SUBOLLS.

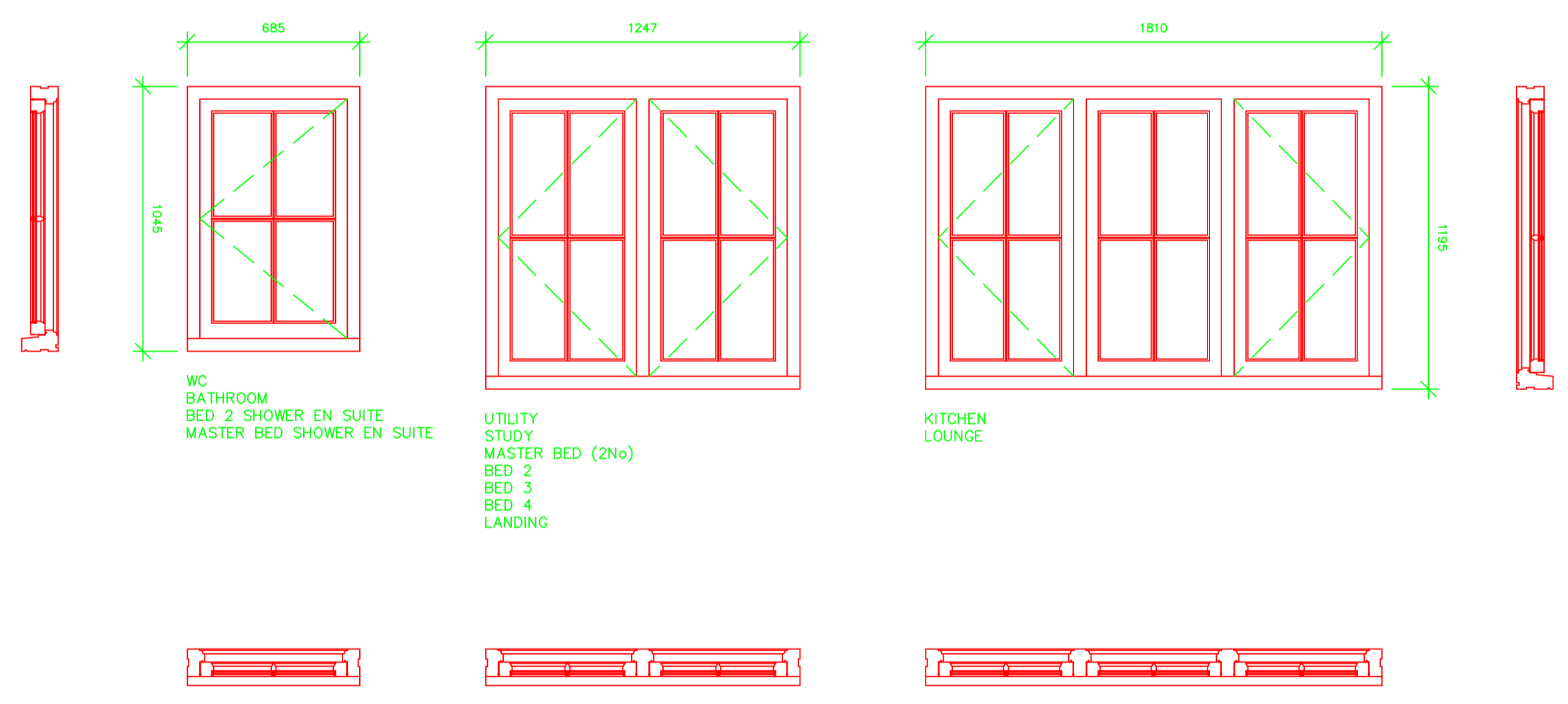
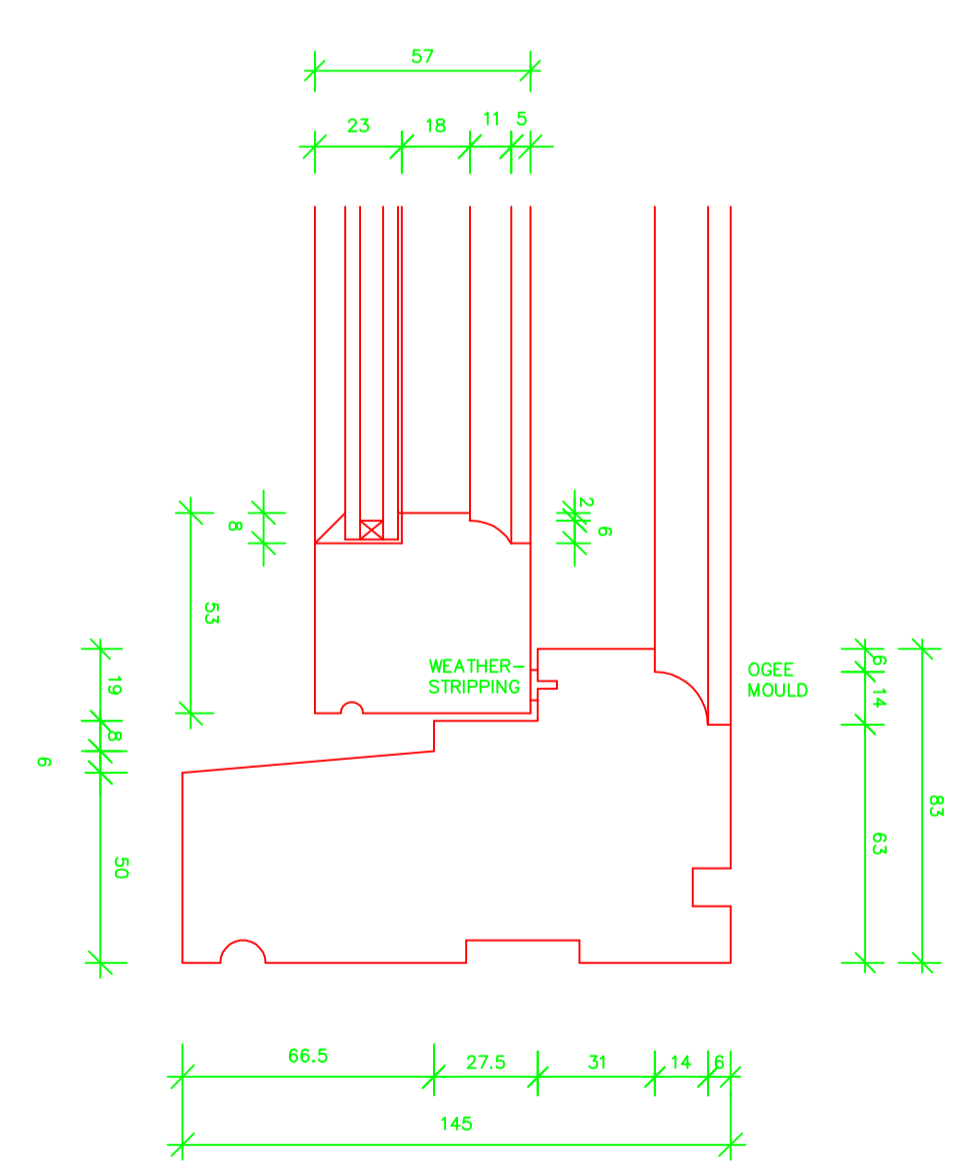
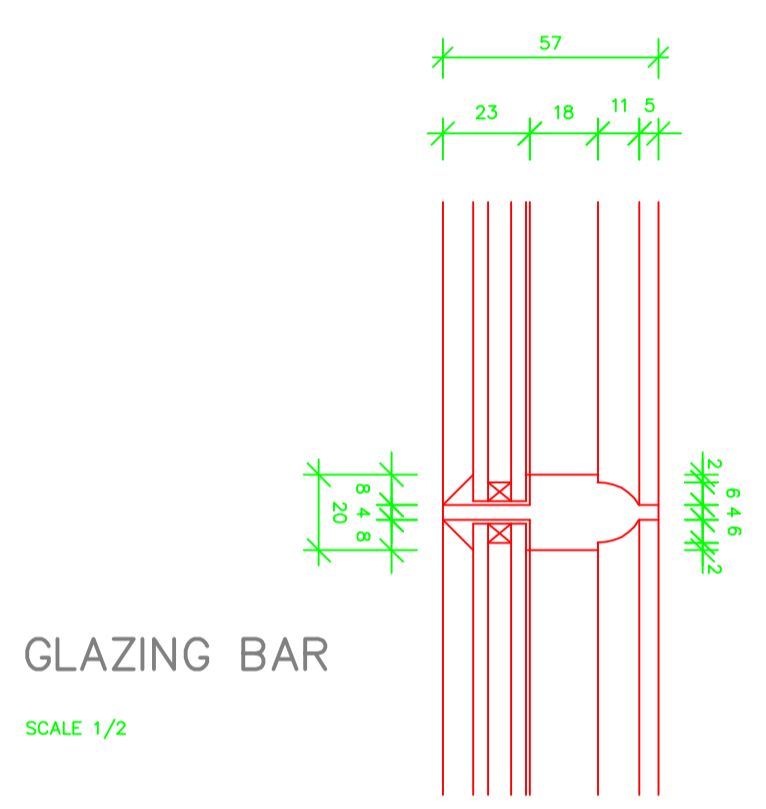
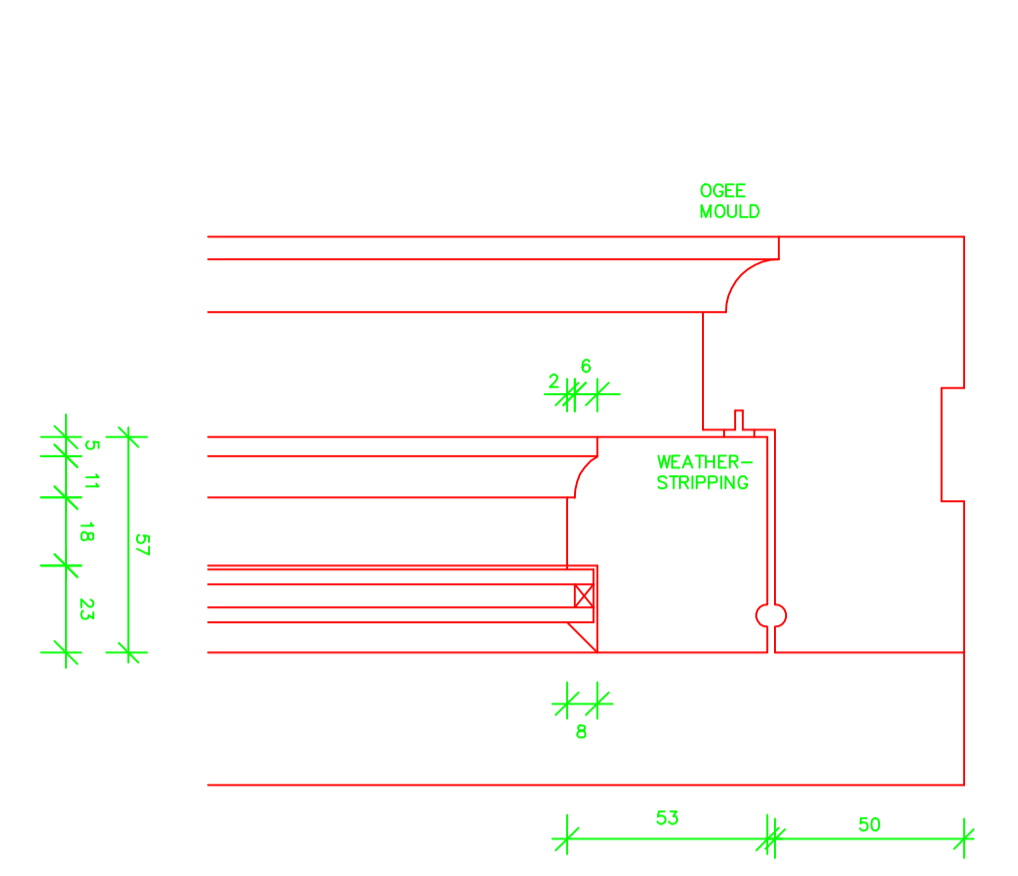
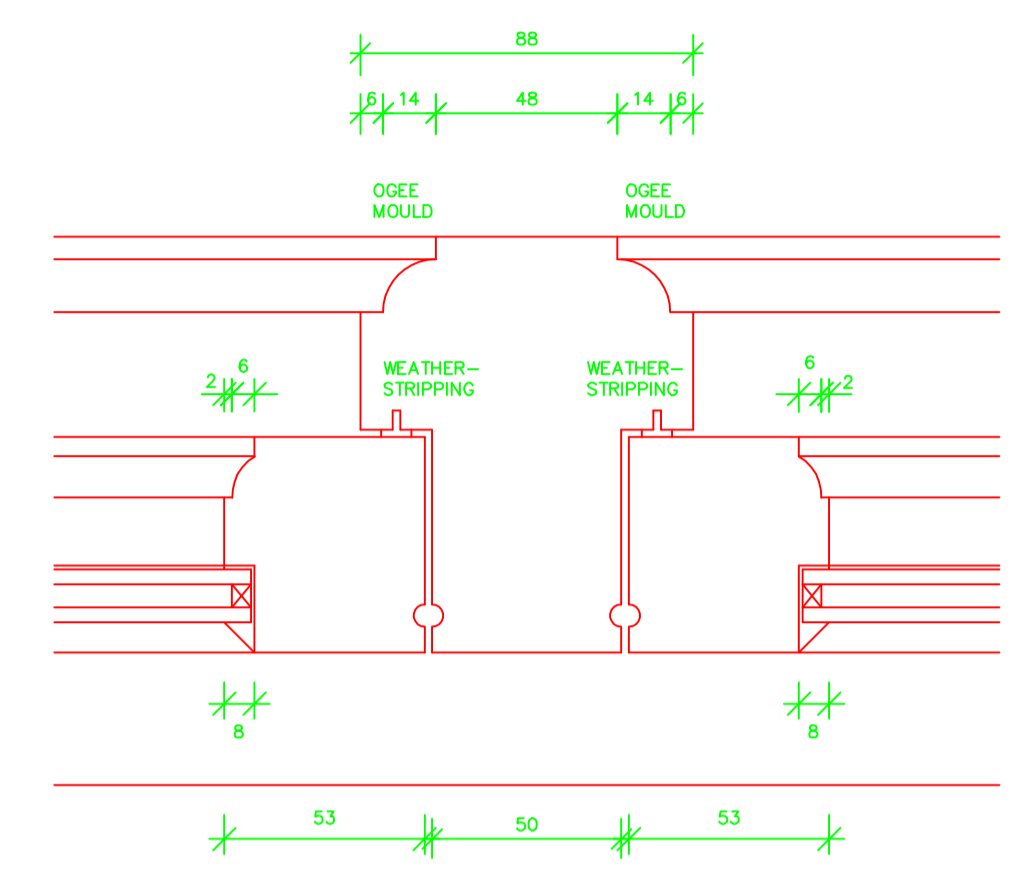
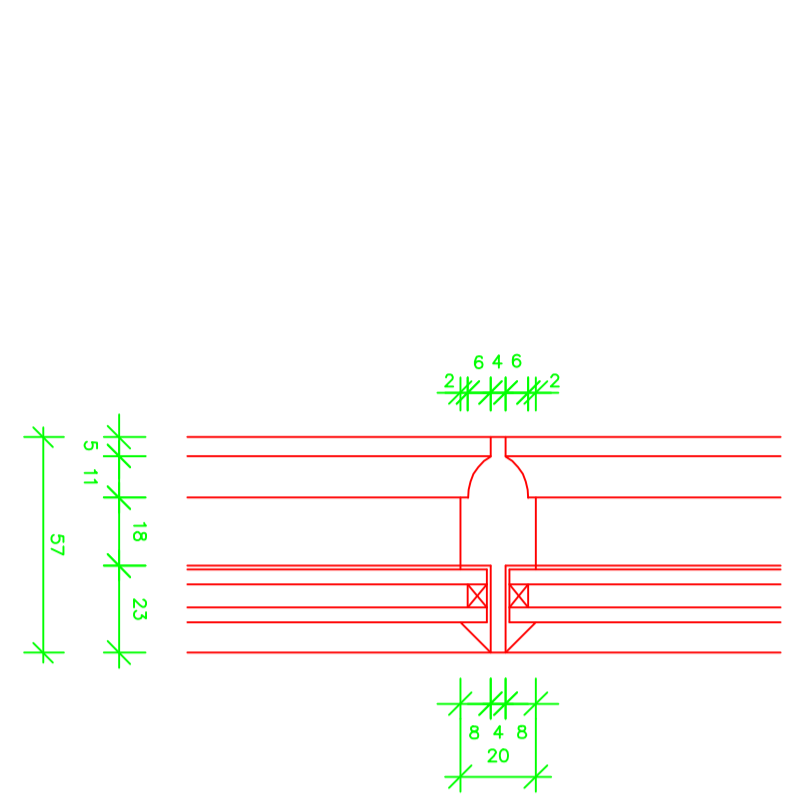
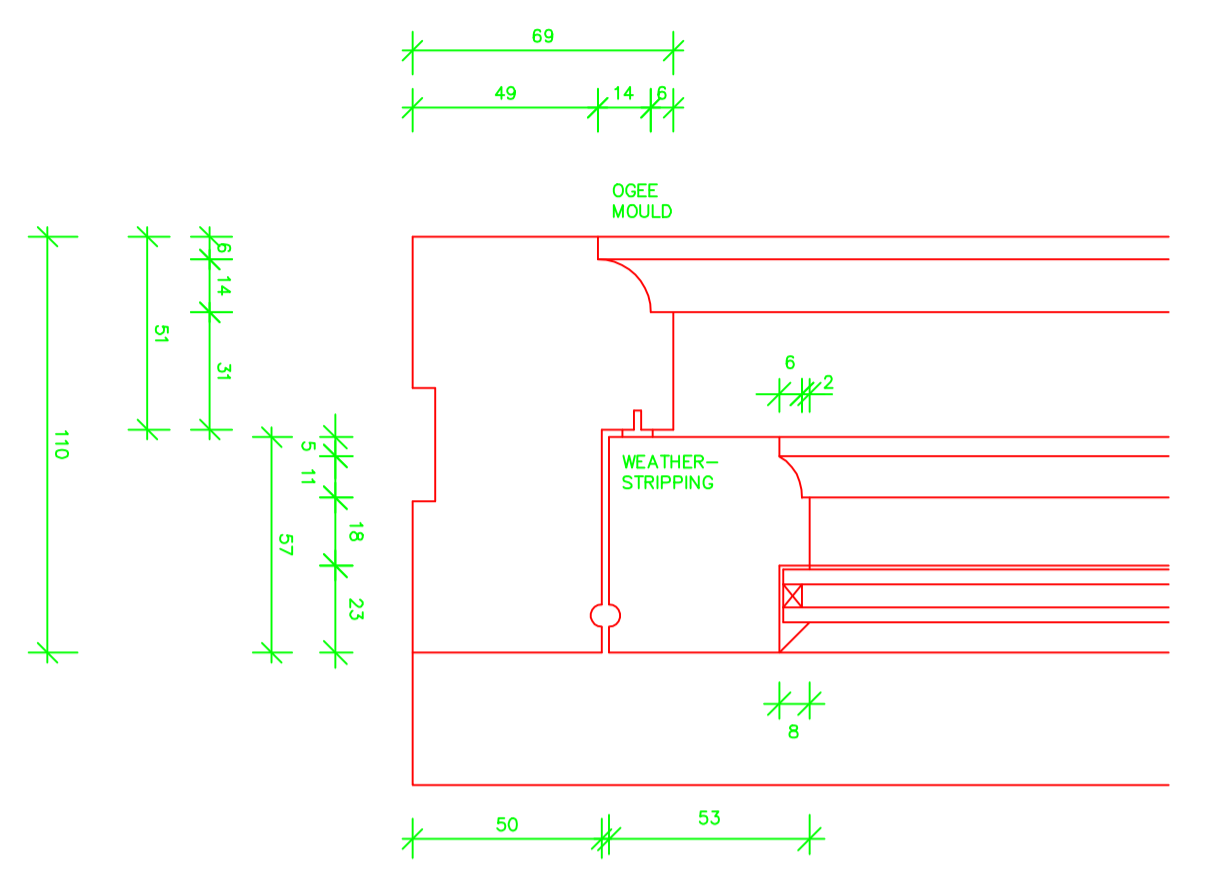
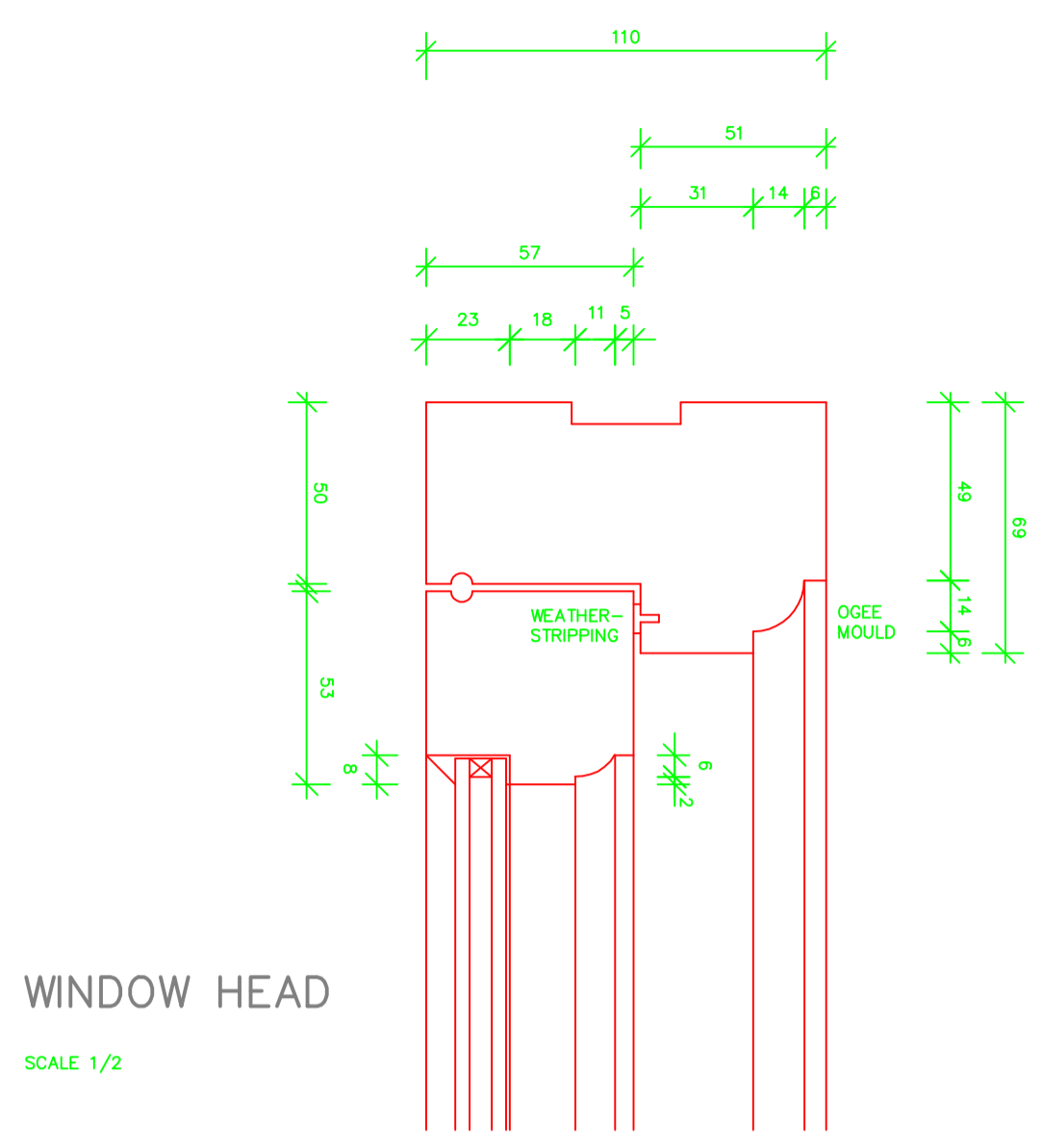

WINDOW JOINERY PLANS, SECTIONS + ELEVATIONS  
 SCALE 1/20

WINDOW COMPONENTS COMPRISING:  
 WINDOWS TO BE TRADITIONAL TIMBER CASEMENT WINDOWS WITH FLUSH PROFILE, PROJECTING CILLS AND OPENING CASEMENTS MANUFACTURED IN DOUBLE VACUUM PRESERVATIVE TREATED GOOD QUALITY JOINERY SOFTWOOD AND SHOP PRIMED AND SPRAY PAINTED WITH TWO COATS HIGH BUILD MICROPOROUS PAINT UNDERCOAT AND ONE COAT HIGH BUILD MICROPOROUS PAINT FINISHING COAT.  
 MEMBER SECTION SIZES AND PROFILES AS DETAILED AND ALL MEMBERS TO BE MORTICED, TENONED, GLED AND DOWELLED TOGETHER.  
 WINDOW FRAMES TO BE FULLY WEATHER-STRIPPED.  
 WINDOW FRAMES INSTALLED INTO PREFORMED MASONRY OPENINGS COMPLETE WITH SEALANT POINTING EXTERNALLY.  
 WINDOWS TO BE SHOP DOUBLE GLAZED WITH CLEAR/OBSCURE 'SLIMLITE' 14MM THICK (4/6/4MM) SEALED DOUBLE GLASS UNITS USING LOW-E GLASS WITH CAVITY FILLED WITH INERT GAS PROVIDING A COMPONENT U/V VALUE NOT EXCEEDING 1.6W/m<sup>2</sup> K. GLAZING UNITS TO BE BEZELLED IN NON-HARDENING BUTYL GLAZING COMPOUND AND HELD IN POSITION USING METAL DIAMOND SPRINGS FIXED USING SPRINGING GUN WITH SPIRGS AT MAXIMUM 150MM CTS. FORE PUTTY TO BE UNSEED OIL PUTTY CARRIED OUT IN ACCORDANCE WITH BS6262 TO DEPTH OF REBATE SIGHT LINE OR JUST BELOW TO ALLOW FOR PAINT FINISH LINE ON PUTTY. PUTTY SHOULD NOT BE PAINTED FOR AT SEVEN DAYS.  
 WINDOW IRONMONGERY TO BE SELECTED BY EMPLOYER AND COMPRISE SECURITY LOCKING SYSTEM WITH LOCKING HANDLES, WINDOW CASEMENT STAYS, HINGES AND BOLTS AS REQUIRED.

Client  
 MR + MRS URDA.

Project  
 PROPOSED REPLACEMENT DWELLING + GARAGE, 18 MILL LANE, POULSHOT, DEVIZES, WILTSHIRE. SN10 1SA

Drawing Title  
 WORKING DRAWING. JOINERY DETAILS. SHEET 1.

Scale	Date	Drawn by
AS INDICATED	AUG 2011	

**Tim Weeding**  
 Building Design Services  
 30 Mill Road  
 Worton  
 Devizes  
 Wiltshire SN10 5SP  
 Telephone & Fax :  
 (01380) 726903

Project Number	Drawing Number
2010-21	25A