

All dimensions must be checked on site and not scaled from this drawing.

Revisions

- A 21 JULY 2009  
ELECTRICAL INSTALLATION TO SITTING ROOM, STUDY, HALL AND WC MODIFIED IN ACCORDANCE WITH EMPLOYERS REQUIREMENTS.
- B 24 JULY 2009  
ELECTRICAL INSTALLATION TO REMAINDER OF HOUSE MODIFIED IN ACCORDANCE WITH EMPLOYERS REQUIREMENTS.
- C 14 AUG 2009  
STAIRCASE FLIGHTS AMENDED AND DRWG GENERALLY UPDATED.

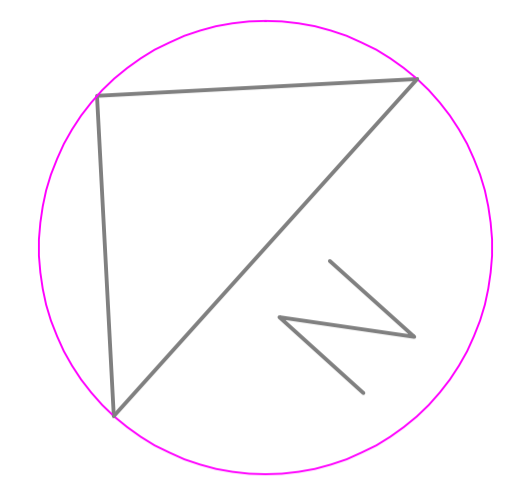

KEY TO ELECTRICAL SYMBOLS

- 13A SINGLE SWITCHED SOCKET OUTLET  
600MM ABOVE FLOOR LEVEL  
150MM ABOVE WORKTOP LEVEL
- 13A DOUBLE SWITCHED SOCKET OUTLET  
600MM ABOVE FLOOR LEVEL  
150MM ABOVE WORKTOP LEVEL
- 13A SWITCHED FUSED SPUR UNIT 150MM  
ABOVE WORKTOP LEVEL WIRED DOWN TO  
13A UNSWITCHED SOCKET OUTLET BEHIND  
APPLIANCE POSITION 600MM ABOVE FLOOR  
LEVEL FOR CONNECTION OF DISHWASHER,  
FRIDGE AND WASHING MACHINE.
- 45A COOKER CONTROL UNIT 150MM ABOVE  
WORKTOP LEVEL WIRED DOWN TO COOKER  
CONNECTION UNIT BEHIND APPLIANCE POSITION  
600MM ABOVE FLOOR LEVEL.
- ONE-WAY OR INTERMEDIATE LIGHT SWITCH  
1350MM ABOVE FLOOR LEVEL  
150MM FROM SIDE OF DOOR
- TWO-WAY LIGHT SWITCH  
1350MM ABOVE FLOOR LEVEL  
150MM FROM SIDE OF DOOR
- CEILING MOUNTED PULL-CHORD LIGHT SWITCH
- PENDANT LIGHT FITTING
- WALL LIGHT FITTING  
FIX ONLY LIGHT FITTING TO BE  
SUPPLIED BY EMPLOYER
- CEILING RECESSED SPOT LIGHT FITTINGS.  
FIX ONLY LIGHT FITTINGS TO BE  
SUPPLIED BY EMPLOYER
- EXTERNAL WALL LIGHT FITTING  
FIX ONLY LIGHT FITTING TO BE  
SUPPLIED BY EMPLOYER
- EXTERNAL BULKHEAD LIGHT FITTING  
FIX ONLY LIGHT FITTING TO BE  
SUPPLIED BY EMPLOYER
- SHOWERLIGHT FITTING TO BE  
SELECTED BY EMPLOYER
- MAINS OPERATED INTERLINKED SMOKE ALARMS  
COMPLETE WITH STAND-BY TROUBLE CHARGED  
BATTERY.
- EXTRACT FAN  
EXTRACT VENTILATION TO BATHROOMS PROVIDED BY WALL  
MOUNTED EXTRACT FAN CAPABLE OF EXTRACTION AT  
MINIMUM RATE 15 LITRES/SEC OPERATED BY HUMIDISTAT  
CONTROL. EXTRACT FAN COMPLETE WITH EXTRACT DUCT  
THROUGH EXTERNAL WALL WITH EXTERNAL GRILLE.
- 13A SWITCHED FUSED SPUR UNIT AT H/L  
WIRED TO HUMIDISTAT CONTROL UNIT AND  
EXTRACT FAN
- EXTRACT FAN  
EXTRACT VENTILATION TO GROUND FLOOR WC PROVIDED  
BY WALL MOUNTED EXTRACT FAN CAPABLE OF EXTRACTION  
AT MINIMUM RATE 6 LITRES/SEC MANUALLY OPERATED.  
WITH 15 MINUTE RUN-ON. EXTRACT FAN COMPLETE WITH  
EXTRACT DUCT THROUGH EXTERNAL WALL WITH EXTERNAL  
GRILLE.
- EXTRACT HOOD  
EXTRACT VENTILATION TO KITCHEN PROVIDED BY EXTRACTOR  
HOOD LOCATED OVER COOKER POSITION AND CAPABLE OF  
EXTRACTION AT MIN. RATE 30 LITRES/SEC MANUALLY OPERATED.  
EXTRACTOR HOOD COMPLETE WITH EXTRACT DUCT THROUGH  
EXTERNAL WALL WITH EXTERNAL GRILLE.
- 13A SWITCHED SPUR UNIT LOCATED 150MM  
ABOVE WORKTOP LEVEL WIRED TO EXTRACT  
HOOD.
- TV/FM CO-AXIAL SOCKET OUTLET  
600MM ABOVE FLOOR LEVEL.

FOUL + STORMWATER DRAINAGE NOTES.

EXCAVATE FOR FOUL + STORMWATER DRAINAGE RUNS TO LINES AND LEVELS INDICATED ON DRAWING AND HAND TRIM AND CONSOLIDATE BASE OF EXCAVATIONS AS REQUIRED.

FOUL + STORMWATER DRAINAGE CONSTRUCTED IN 110/160MM DIA OSMAADRAIN, OR EQUAL APPROVED, UPVIC PIPE AND FITTINGS CONFORMING WITH THE RELEVANT CLAUSES OF BS4686 AND BS4541 WITH RING SEAL FLEXIBLE COUPLINGS AND DRAINAGE PIPEWORK LAD TO FALLS INDICATED ON DRAWING.

DRAINS UNDER BUILDING TO RECEIVE 100MM THICK 10MM SINGLE SIZE GRAVEL BED AND SURROUND AND DRAINAGE TRENCHES BACKFILLED AND CONSOLIDATED WITH TYPE 2 GRANULAR HARDWARE MATERIAL.

DRAINS BENEATH FOOTPATH/SOFT LANDSCAPING AREAS EXTERNAL TO BUILDING TO BE LAID WITH 100MM THICK 10MM SINGLE SIZE GRAVEL BED AND SURROUND AND DRAINAGE TRENCHES BACKFILLED WITH SELECTED MATERIAL FROM EXCAVATION HAND PLACED AND COMPACTED IN LAYERS. WHERE DRAINS HAVE LESS THAN 450MM COVER OVER CROWN OF PIPES FORM PROTECTION TO DRAIN BY LAYING PRECAST CONCRETE PAVING SLABS AS BRIDGING SLAB OVER LINE OF DRAIN WITH SLABS LAID OVER GRAVEL SURROUND TO PIPES.

NEW SVP CONNECTION FORMED USING 40.581 LONG RADIUS BEND AND SHORT LENGTH OF PIPE AND TERMINATE WITH COULDER AT FINISHED GROUND FLOOR LEVEL TO RECEIVE CONNECTION FROM SVP.

EXTO/NEW RWP'S TO DISCHARGE OVER NEW RIDDABLE BOTTLE GULLIES FORMED WITH POLYPIRE BUILDING PRODUCTS LTD, OR EQUAL APPROVED, US425AST 110MM PLAIN BOTTLE GULLIES COMPLETE WITH ROUND POLYPROPYLENE GRID AND ANTI-SPLASH CONCRETE SURROUND. CONCRETE SURROUND TO BE SET AT FINISHED EXTERNAL GROUND/PAVING LEVEL. BASE OF RWP'S TO RECEIVE RAINWATER SHOE TO DISCHARGE OVER GULLY.

DRAINAGE CONNECTION POINTS TO BE INSTALLED IN STRICT ACCORDANCE WITH MANUFACTURERS RECOMMENDATIONS AND TO BE BEDDED AND SURROUNDED IN CONCRETE TO LOCATE ASSEMBLIES FIRMLY IN POSITION.

FOUL + STORMWATER SHALLOW INSPECTION CHAMBERS FORMED WITH STANDARD POLYPROPYLENE 40.820 STRAIGHT THROUGH CHAMBER BASE / 40.851 SINGLE 45 DEG LH CHAMBER BASE AS REQUIRED WITH 40.800 CHAMBER SHAFTS CUT TO DEPTH AS REQUIRED. CHAMBERS TO BE BEDDED ON 100MM THICK 10MM SINGLE SIZE GRAVEL BED AND BACKFILL AROUND CHAMBERS WITH MINIMUM 150MM THICK 10MM SINGLE SIZE GRAVEL PLACED AND COMPACTED IN LAYERS. CHAMBER COVER AND FRAME TO BE 250MM DIA LIGHT DUTY ALUMINIUM SEALED COVER AND FRAME FORM 100MM THICK GRADE C20P CONCRETE COLLAR AROUND CHAMBERS WITH TOP OF COLLAR AND CHAMBER COVER AT FINISHED EXTERNAL GROUND/PAVING LEVEL.

FOUL + STORMWATER MANHOLES FORMED WITH STANDARD POLYPROPYLENE UNIVERSAL INSPECTION CHAMBERS WITH 570/910MM DEPTH OR CUT TO DEPTH AS REQUIRED AND WITH 110MM DIA INLET AND OUTLET DIAMETERS. CHAMBERS BEDDED ON 100MM THICK 10MM SINGLE SIZE GRAVEL BED AND BACKFILL AROUND CHAMBERS WITH MINIMUM 150MM THICK 10MM SINGLE SIZE GRAVEL PLACED AND COMPACTED IN LAYERS. MANHOLES TO RECEIVE 450MM DIA LIGHT DUTY CAST IRON SEALED COVER AND FRAME FORM 100MM THICK GRADE C20P CONCRETE COLLAR AROUND CHAMBERS WITH TOP OF COLLAR AND MANHOLE COVERS AT FINISHED EXTERNAL GROUND/PAVING LEVEL.

FOUL DRAINAGE RIDDING EYE FORMED WITH 45 DEG SHORT RADIUS BEND AND 110MM DIA RAKING PIPE WITH DRAINAGE PIPEWORK BEDDED AND SURROUNDED IN MINIMUM 100MM THICK 10MM SINGLE SIZE GRAVEL PLACED AND COMPACTED IN LAYERS. RIDDING EYE COVER AND FRAME TO BE 40.256 LIGHT DUTY SEALED RIDDING EYE COVER AND FORM 100MM THICK GRADE C20P CONCRETE COLLAR AROUND RIDDING EYE WITH TOP OF COLLAR AND RIDDING EYE COVER AT FINISHED EXTERNAL GROUND/PAVING LEVEL.

ALL DRAINAGE TO BE TESTED ON COMPLETION IN ACCORDANCE WITH CP2005:1968 OR CP301:1971.

FRENCH DRAINAGE NOTES.

EXCAVATE FOR FRENCH DRAINAGE RUNS TO LINES AND LEVELS INDICATED ON DRAWING AND HAND TRIM AND CONSOLIDATE BASE OF EXCAVATIONS AS REQUIRED.

LINE TRENCH EXCAVATIONS WITH 'TERRAM' GEOTECHNIC FABRIC AND FORM FRENCH DRAINS IN OSMAADRAIN, OR EQUAL APPROVED, 110MM DIA PERFORATED PIPE LAID WITH PERFORATIONS UPPERMOST AND WITH PIPEWORK LAID IN MINIMUM 150MM THICK 10MM SINGLE SIZE GRAVEL BED AND SURROUND. WRAP 'TERRAM' OVER TOP OF GRAVEL SURROUND AND BACKFILL TRENCH EXCAVATIONS WITH SELECTED MATERIAL FROM EXCAVATIONS.

MAKE GOOD EXTERNAL GROUND SURFACES / EXTERNAL PAVINGS AS REQUIRED.

GROUND FLOOR PLAN.

TYPICAL SECTION THROUGH FRENCH DRAIN

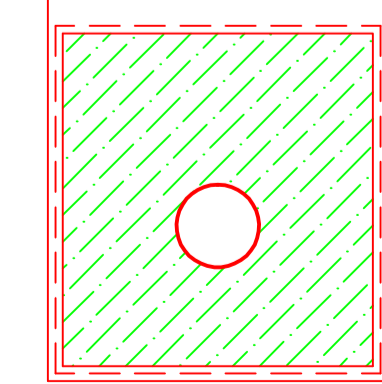

SCALE 1/10

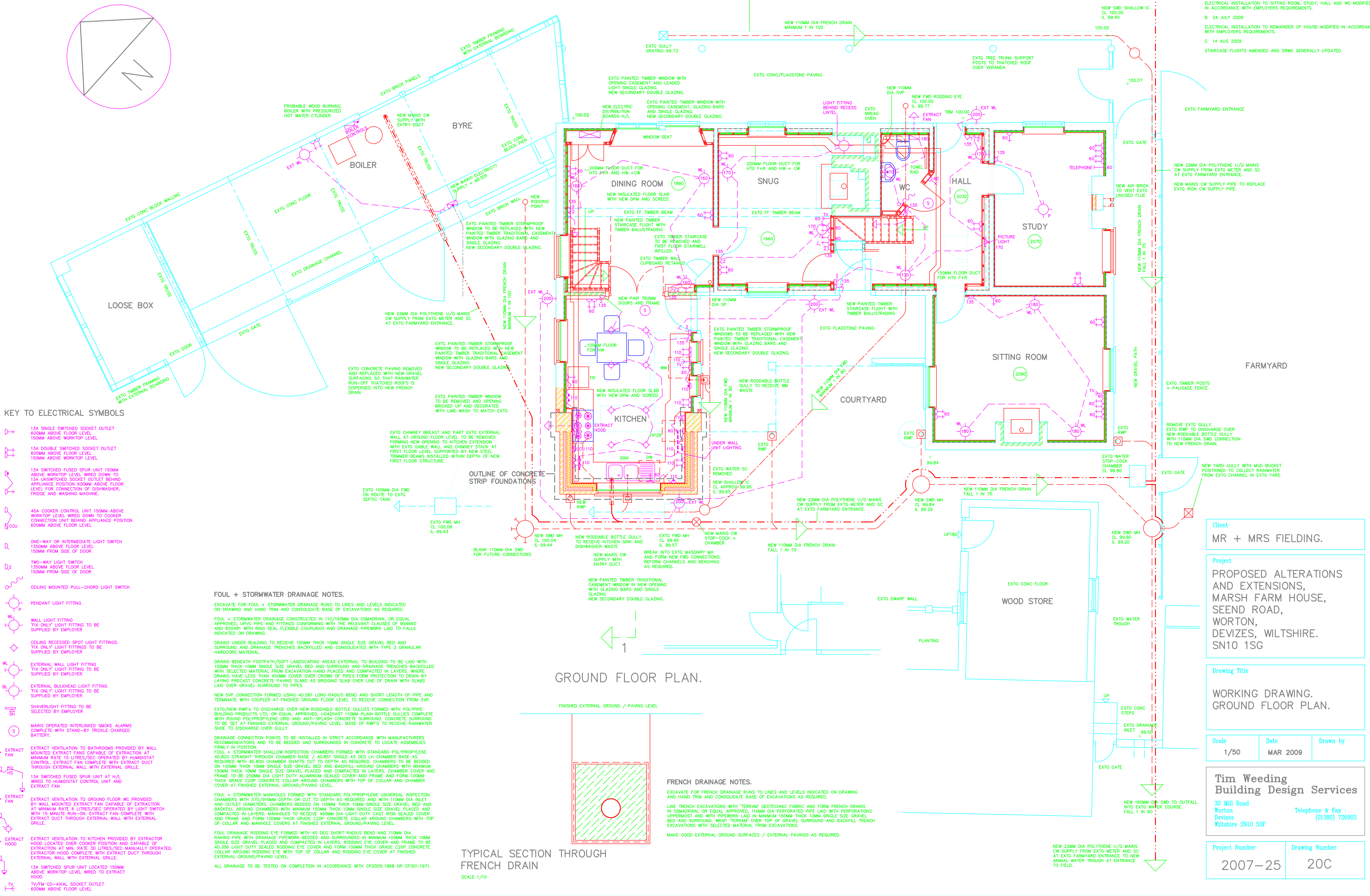

Client  
**MR + MRS FIELDING.**

Project  
**PROPOSED ALTERATIONS AND EXTENSIONS, MARSH FARM HOUSE, SEEND ROAD, WORTON, DEVIZES, WILTSHIRE. SN10 1SG**

Drawing Title  
**WORKING DRAWING. GROUND FLOOR PLAN.**

Scale 1/50	Date MAR 2009	Drawn by
---------------	------------------	----------

Tim Weeding  
Building Design Services  
30 Mill Road  
Worton  
Devizes  
Wiltshire SN10 5SP  
Telephone & Fax :  
(01380) 726903

Project Number 2007-25	Drawing Number 20C
---------------------------	-----------------------